

Compact bearing series

LMCHP LUU-LMCHP16LUU|LHICKW16|LML72-d16

参数信息:

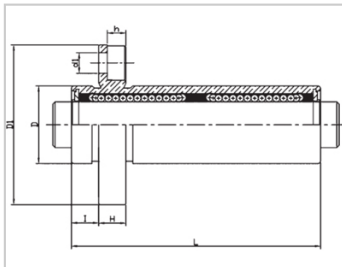
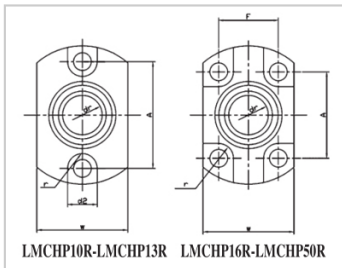

Model No. :

| | |
|---|------------|
| YTP : | LMCHP16LUU |
| MISUMI : | LHICKW16 |
| YHDA : | LML72-d16 |
| NUMBER OF BALL ROWS : | |
| Column : | 6 |
| Boundary dimensions : | |
| INSCRIBED CIRCLE DIAMETER _{dr} : | 16 |
| INSCRIBED CIRCLE DIAMETER TOLERANCE : | 0-0.010 |
| OUTER DIAMETER _D : | 26 |
| Outer Diameter Tolerance : | 0-0.016 |
| Length _L : | 70 |
| Length Tolerance : | ± 0.3 |
| I : | 6 |
| Flange _{D1} : | 44 |
| Flange _W : | 32 |
| Flange _H : | 6 |
| Flange _A : | 27 |
| Flange _F : | 24 |
| HOLE FOR ATTACHMENT _{d1} : | 4.5 |
| HOLE FOR ATTACHMENT _{d2} : | 7.5 |
| HOLE FOR | 4.1 |

| | |
|------------------------|-------|
| ATTACHMENTh : | |
| HOLE FOR ATTACHMENTr : | 3.75 |
| SOUAR- ENESS : | 0.015 |
| Eccentricity (MAX.) : | 0.015 |
| Basic Load Rating : | |
| C(kgf) : | 96.5 |
| Co(kgf) : | 143 |
| Weight : | |
| (g) : | 141 |

介绍:

| Model No. | Producti on Standards | Outer Coving | | | Balls | | Retainer | | Seals Material | |
|------------|-----------------------|--------------|------------------|-----------------------------|----------|------------------|----------|-----------------------------|----------------|----------------|
| | | Material | Hardness (HRC) | Treatmen t Of Surfaces | Material | Hardness (HRC) | Material | Holder Working Temperat ure | Skeleton | Rubber |
| LMCHP LUU | GB/T169 40-2012 | GCr15 | 60 ~ 64 | - | GCr15 | 61 ~ 66 | Resin | -20 ~ 80 | 65Mn | Nitrile Rubber |
| LMCHP LAUU | GB/T169 40-2012 | GCr15 | 60 ~ 64 | Electroles s Nickel Plating | GCr15 | 61 ~ 66 | Resin | -20 ~ 80 | 65Mn | Nitrile Rubber |

Note: Not produced, for reference only.