

Linear bearing standard series

LM UU-AJ -LM6UU-AJLMC41-d6SM6GUU-AJ

参数信息:

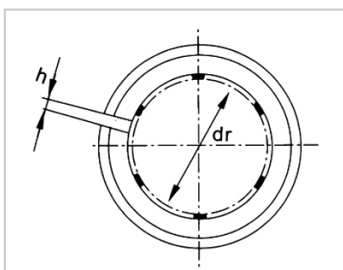
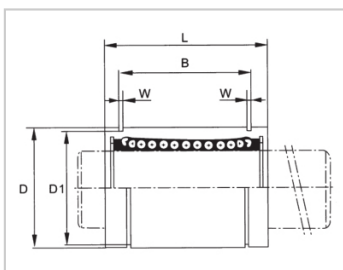

model :

|                          |           |
|--------------------------|-----------|
| YTP (Resin Retainer) :   | LM6UU-AJ  |
| YTP (Steel Protection) : | LM6M-AJ   |
| YHDA :                   | LMC41-d6  |
| NB :                     | SM6GUU-AJ |
| SAMICK :                 | LM6UU-AJ  |

Number of Ball Columns :

column : 4

weight :

( g ) : 7.6

Main dimensions :

|                               |          |
|-------------------------------|----------|
| Inner diameter dr :           | 6        |
| Inner diameter tolerance :    | 0 -0.009 |
| Outer diameter D :            | 12       |
| Outer diameter tolerance :    | 0 -0.011 |
| Length L :                    | 19       |
| Length tolerance :            | 0 -0.20  |
| External stop groove B :      | 13.5     |
| Outer stop groove tolerance : | 0 -0.20  |
| External stop groove D1 :     | 11.5     |
| W :                           | 1.1      |
| h :                           | 1        |

Radial runout(MAX.) : 0.012

Basic rated load :

C(kgf) : 21  
Co(kgf) : 27

介绍:

| Model     | Producti on standard | Shell    |                |                            | rolling ball |                | Retainer            |                     | Accessory (seal) material |                |
|-----------|----------------------|----------|----------------|----------------------------|--------------|----------------|---------------------|---------------------|---------------------------|----------------|
|           |                      | Material | Hardness (HRC) | Surface treatment          | Material     | Hardness (HRC) | Material            | Using te mperatur e | Skeleton                  | Rubber         |
| LM UU-AJ  | GB/T169 40-2012      | GCr15    | 60 ~ 64        | -                          | GCr15        | 61 ~ 66        | Resin               | -20 ~ 80            | 65Mn                      | Nitrile rubber |
| LM AUU-AJ | GB/T169 40-2012      | GCr15    | 60 ~ 64        | Electroless nickel plating | GCr15        | 61 ~ 66        | Resin               | -20 ~ 80            | 65Mn                      | Nitrile rubber |
| LM M-AJ   | GB/T169 40-2012      | GCr15    | 60 ~ 64        | -                          | GCr15        | 61 ~ 66        | 304 stainless steel | -20 ~ 150           | 65Mn                      | -              |
| LM AM-AJ  | GB/T169 40-2012      | GCr15    | 60 ~ 64        | Electroless nickel plating | GCr15        | 61 ~ 66        | 304 stainless steel | -20 ~ 150           | 65Mn                      | -              |