

Compact bearing series

LMCHC LAUU-LMCHC8LAUU

参数信息:

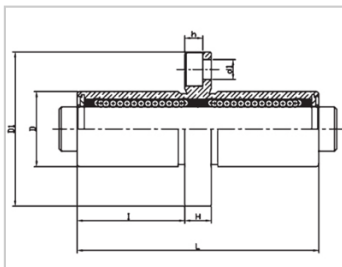
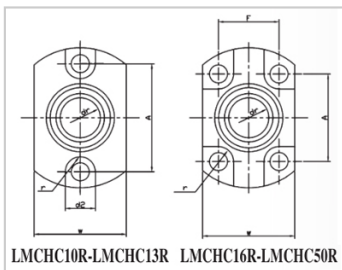

Model No. :

YTP (nickel plated) : LMCHC8
LAUU

NUMBER OF BALL
ROWS :

Column : 6

Boundary
dimensions :

INSCRIBED CIRCLE
DIAMETER_{dr} : 8

INSCRIBED CIRCLE
DIAMETER
TOLERANCE : 0-0.010

OUTER
DIAMETER_D : 13

Outer
DiameterTolerance : 0-0.013

Length_L : 45

LengthTolerance : ± 0.3

I : 20

Flange_{D1} : 28

Flange_W : 19

Flange_H : 5

Flange_A : 22

Flange_F : -

HOLE FOR
ATTACHMENT_{d1} : 3.5

HOLE FOR
ATTACHMENT_{d2} : 6

HOLE FOR
ATTACHMENT_h : 3.1

HOLE FOR
ATTACHMENT_r : 3

SOUAR- ENESS : 0.015

Eccentricity (MAX.) : 0.015

Basic Load Rating :

C(kgf) : 38.3

Co(kgf) : 55.5

Weight :

(g) : 35

介绍:

Model No.	Production Standards	Outer Coving			Balls		Retainer		Seals Material	
		Material	Hardness (HRC)	Treatment Of Surfaces	Material	Hardness (HRC)	Material	Holder Working Temperature	Skeleton	Rubber
LMCHC LUU	GB/T16940-2012	GCr15	60 ~ 64	-	GCr15	61 ~ 66	Resin	-20 ~ 80	65Mn	Nitrile Rubber
LMCHC LAUU	GB/T16940-2012	GCr15	60 ~ 64	Electroless Nickel Plating	GCr15	61 ~ 66	Resin	-20 ~ 80	65Mn	Nitrile Rubber

Note: Not produced, for reference only.