

Compact bearing series

LMCHC LAUU-LMCHC10LAUU

参数信息:

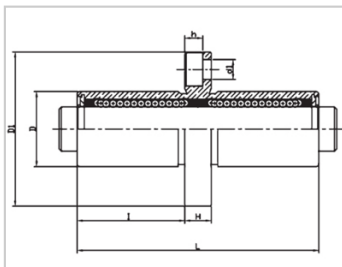
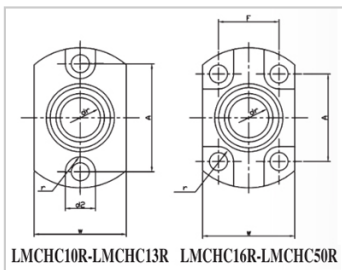

Model No. :

YTP (nickel plated) : LMCHC10LAUU

NUMBER OF BALL ROWS :

Column : 6

Boundary dimensions :

INSCRIBED CIRCLE DIAMETER<sub>dr</sub> : 10

INSCRIBED CIRCLE DIAMETER TOLERANCE : 0-0.010

OUTER DIAMETER<sub>D</sub> : 17

Outer Diameter Tolerance : 0-0.013

Length<sub>L</sub> : 55

Length Tolerance : ± 0.3

I : 24.5

Flange<sub>D1</sub> : 35

Flange<sub>W</sub> : 23

Flange<sub>H</sub> : 6

Flange<sub>A</sub> : 27

Flange<sub>F</sub> : -

HOLE FOR ATTACHMENT<sub>d1</sub> : 4.5

HOLE FOR ATTACHMENT<sub>d2</sub> : 7.5

HOLE FOR ATTACHMENT<sub>h</sub> : 4.1

HOLE FOR ATTACHMENT<sub>r</sub> : 3.75

SOUAR- ENESS : 0.015

Eccentricity (MAX.) : 0.015

Basic Load Rating :

C(kgf) : 58.5

Co(kgf) : 86.7

Weight :

(g) : 73

介绍:

Model No.	Production Standards	Outer Coving			Balls		Retainer		Seals Material	
		Material	Hardness ( HRC )	Treatment Of Surfaces	Material	Hardness ( HRC )	Material	Holder Working Temperature	Skeleton	Rubber
LMCHC LUU	GB/T16940-2012	GCr15	60 ~ 64	-	GCr15	61 ~ 66	Resin	-20 ~ 80	65Mn	Nitrile Rubber
LMCHC LAUU	GB/T16940-2012	GCr15	60 ~ 64	Electroless Nickel Plating	GCr15	61 ~ 66	Resin	-20 ~ 80	65Mn	Nitrile Rubber

Note: Not produced, for reference only.